



Supplemental Hose and Mask
Maintenance System

SoClean.com

User Manual

THANK YOU FOR CHOOSING SOCLEAN!

We hope you enjoy making SoClean 2 part of your daily maintenance routine.

TABLE OF CONTENTS

INDICATIONS FOR USE, CONTRAINDICATIONS, SPECIFICATIONS, WARNINGS & CAUTIONS.....	2
HOW DOES MY SOCLEAN 2 WORK?.....	4
MANUFACTURER, SYMBOLS & FCC NOTICE	5
INCLUDED WITH YOUR SOCLEAN 2.....	6
SOCLEAN 2 CONTROL PANEL	10
WASH, RINSE AND DRY YOUR SLEEP EQUIPMENT HOSE AND MASK.....	12
USING THE HOSE AND MASK ADAPTER WITH YOUR SOCLEAN 2.....	13
USING THE HOSE SLEEVE	16
CONNECT POWER	17
SET LANGUAGE, CLOCK & CYCLE SCHEDULE.....	18
USING YOUR SOCLEAN 2	22
RECONNECTING YOUR SLEEP EQUIPMENT	24
CARE & MAINTENANCE OF YOUR SOCLEAN 2	25
FAQ	26



INDICATIONS FOR USE, CONTRAINDICATIONS, SPECIFICATIONS, WARNINGS & CAUTIONS

Indications for Use: The SoClean 2 device is intended to be used to supplement maintenance procedures for home use sleep equipment masks and hoses.

Contraindications for Use: Persons with underlying lung diseases, such as asthma and chronic obstructive pulmonary disease (also known as COPD, which includes emphysema and chronic bronchitis), and those with cardiovascular disease may be sensitive to ozone and should consult with their health care professional before using this product. Safety in pregnant or breastfeeding women and children under the age of 22 have not been established. Consult with your health care professional before using this product.

Specifications:

Electrical Characteristics:

AC Adapter input: AC 100~240V, 50/60HZ, 0.5A

AC Adapter output: DC 12V, 1.5A Max

Power Consumption: 18W Max

Environmental Characteristics:

Operating: 10°C to 38°C (50°F to 100°F),
15% to 70% humidity

Storage and Transport Conditions:

-20°C to +55°C (-4°F to 131°F),
15% to 70% humidity

Ozone Concentration:









When operated in a 125 square foot room with 8-foot ceilings, the average ambient ozone concentration in the room over the operating cycle is < 0.05 parts per million (PPM).











Physical Characteristics:

Dimensions: 7.875" x 7.25" x 8.875"

Weight: 5.6 lbs

Cord Length: 4' 8"

-  **WARNING:** Do not use a fragrant essence in the water reservoir or highly fragrant soaps to wash the sleep equipment hose and mask when using the SoClean 2.
-  **WARNING:** Discontinue use if acne or rash develops along mask contact line and call SoClean customer care.
-  **WARNING:** Ensure the correct Clock time and Daily Start Time are set on the SoClean 2 before using your sleep equipment. Pay particular attention to the AM/PM setting if using 12-hr mode. Failure to do so may result in the SoClean 2 operating at an unexpected time.
-  **WARNING:** In the event of loss of power to your home or the SoClean 2, ensure the correct Clock time and Daily Start Time are set on the SoClean 2 before using your sleep equipment. Failure to do so may result in the SoClean 2 operating at an unexpected time.
-  **WARNING:** Regularly inspect your SoClean 2 for physical damage, such as cracks or broken structure, damaged gaskets, and cracks in the sleep equipment hose. Discontinue use if damage is detected and contact SoClean for assistance.
-  **WARNING:** Keep away from water sources including rain, bathtubs, sinks, and pools. To clean your SoClean 2, wipe with a damp cloth. Do not submerge the SoClean 2 in liquid or use chemical cleaners.
-  **WARNING:** Keep away from children. Do not place any living thing inside the SoClean Chamber during use.
-  **WARNING:** Do not inhale from the Ozone Tube or the Ozone Tube outlet on the back of the SoClean 2.
-  **WARNING:** Do not inhale from the Ozone Tube or the Ozone Tube outlet on the back of the SoClean 2.

-  **WARNING:** Do not breathe through your mask if the SoClean 2 is operating a Cycle.
-  **WARNING:** Do not use in explosive air environments, near gas vapors, or other flammables, etc. Do not place any flammable or ignitable items on top of the SoClean 2.
-  **WARNING:** Keep the SoClean Lid closed until the green status light illuminates. Wait a minimum of 30 minutes between completion of the Cycle and use of the sleep equipment mask and hose.
-  **WARNING:** Do not remove gasket from Hose Detect Switch slot.
-  **CAUTION:** The Lid Gasket is removable. Ensure that the Lid Gasket is properly installed before operating a Cycle.
-  **WARNING:** Do not dismantle the SoClean 2.
-  **CAUTION:** Please be sure the black Ozone Tube from the back of the SoClean 2 is connected to the SoClean Adapter before operating the SoClean 2.
-  **WARNING:** When operating your SoClean 2 per the instructions for use, if there is a noticeable scent of ozone or other unfamiliar odor or you experience headache, cough, or shortness of breath, leave the room for 4 hours. Contact SoClean Customer Care before running your machine again.
-  **WARNING:** Do not route your sleep equipment hose through both Hose Detect Slots while or after using your equipment. This may result in the SoClean 2 running at an unexpected time.
-  **WARNING:** Remove clear outer wrapper and blue tape from Cartridge Filter.



Read this instruction manual before operating this device. Your SoClean 2 should be used only according to the procedures described in this manual. If it is used in a manner not specified by SoClean®, the safety protection provided by the equipment may be impaired.

HOW DOES MY SOCLEAN 2 WORK?

SoClean 2 uses ozone. Ozone is contained within the system and is in contact with your sleep equipment hose and mask during the Maintenance Cycle.

SoClean 2 is designed to produce a sufficient level of ozone for maintenance of your sleep equipment hose and mask. The smell of ozone is detectable at low concentrations by some people and you may smell ozone briefly during the Maintenance Cycle.

Ozone naturally breaks down into oxygen in a short amount of time. Your SoClean 2 safely contains ozone within the system until it has converted back to oxygen. The Filter accelerates the process of converting ozone in your SoClean 2 Chamber and your sleep equipment hose and mask into fresh air before the completion of a Maintenance Cycle.

Contraindications for Use:

Persons with underlying lung diseases, such as asthma and chronic obstructive pulmonary disease (also known as COPD, which includes emphysema and chronic bronchitis), and those with cardiovascular disease may be sensitive to ozone and should consult with their health care professional before using this product. Safety in pregnant or breastfeeding women and children under the age of 22 have not been established. Consult with your health care professional before using this product.

Read this instruction manual before operating this device.

Your SoClean 2 should be used only according to the procedures described in this manual. If it is used in a manner not specified by SoClean®, the safety protection provided by the equipment may be impaired.

⚠ WARNING: When operating your SoClean 2 per the instructions for use, if there is a noticeable scent of ozone or other unfamiliar odor or you experience headache, cough, or shortness of breath, leave the room for 4 hours. Contact SoClean Customer Care before running your machine again.

⚠ WARNING: If you are experiencing headaches/migraines, or symptoms such as cough or discomfort in your nose or throat discontinue use and call your health care provider.

⚠ WARNING: Discontinue use and call your health care provider if you experience any cardiopulmonary symptoms.

⚠ WARNING: If your SoClean 2 system is dropped, it may become damaged. Regularly inspect your SoClean 2 for physical damage, such as cracks or broken structure, damaged gaskets, and cracks in the sleep equipment hose. Discontinue use if damage is detected and contact SoClean for assistance.

⚠ CAUTION: Discontinue use of your SoClean 2, consult your health care provider and contact SoClean Customer Care if acne or a rash develops along the mask contact line.

MANUFACTURER, SYMBOLS & FCC NOTICE

Designed by and Manufactured for:

SoClean, Inc., 1 Vose Farm Road, Peterborough, New Hampshire 03458 USA

Produced by: JDI Electronics Factory, China

Symbols



Consult Manual

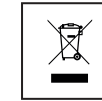

Waste Electrical & Electronic Equipment (WEEE)
It is the responsibility of the end user to dispose of this equipment at a designated collection point.

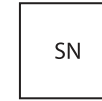

Serial Number



Catalog number



Not made with natural rubber latex



Date of Manufacture



Do not use if package is damaged.

FCC Notice

Please note that changes or modifications not expressly approved by the party responsible for compliance could void the user's authority to operate the equipment.

NOTE: This equipment has been tested and found to comply with the limits for a Class B digital device, pursuant to Part 18 of the FCC Rules. These limits are designed to provide reasonable protection against harmful interference in a residential installation. This equipment generates, uses and can radiate radio frequency energy and, if not installed and used in accordance with the instructions, may cause harmful interference to radio communications. However, there is no guarantee that interference will not occur in a particular installation. If this equipment does cause harmful interference to radio or television reception, which can be determined by turning the equipment off and on, the user is encouraged to try to correct the interference by one or more of the following measures:

- Reorient or relocate the receiving antenna.
- Increase the separation between the equipment and receiver.
- Connect equipment into an outlet on a circuit different from that to which the receiver is connected.
- Consult the dealer or an experienced radio/TV technician for help.

INCLUDED WITH YOUR SOCLEAN 2

Number	Part Name	SKU	Description
1	Removable Hose Slot Plug	PN1214	This allows you to set up the SoClean 2 on either side. Place this plug in the hose slot that you don't use.
2	SoClean Chamber	N/A	Place your mask in here when you run a Maintenance Cycle.
3	Lid Gasket	N/A	Ensures tight seal around the SoClean Chamber when the SoClean Lid is closed. Do not close the Lid without this part in place.
4	SoClean Lid	N/A	Close the Lid after you place your mask in the SoClean Chamber to ensure that the Cycle runs.
5	Cartridge Filter Kit	PN1207UNI	This Cartridge Filter converts ozone back into normal oxygen. Remove outer plastic wrapping and blue tape prior to installation.
6	Hose Detect Switch	N/A	The Hose Detect Switch detects when the SoClean 2 is configured for operation by detecting the presence of the hose in the hose slot when the Lid is closed. If no hose is detected, the SoClean 2 will not run a Cycle. Hose Detect Switch operation can be inspected by gently pushing down and releasing the gray plastic switch and hearing an audible click. The switch should move freely down and up when gently pressed.

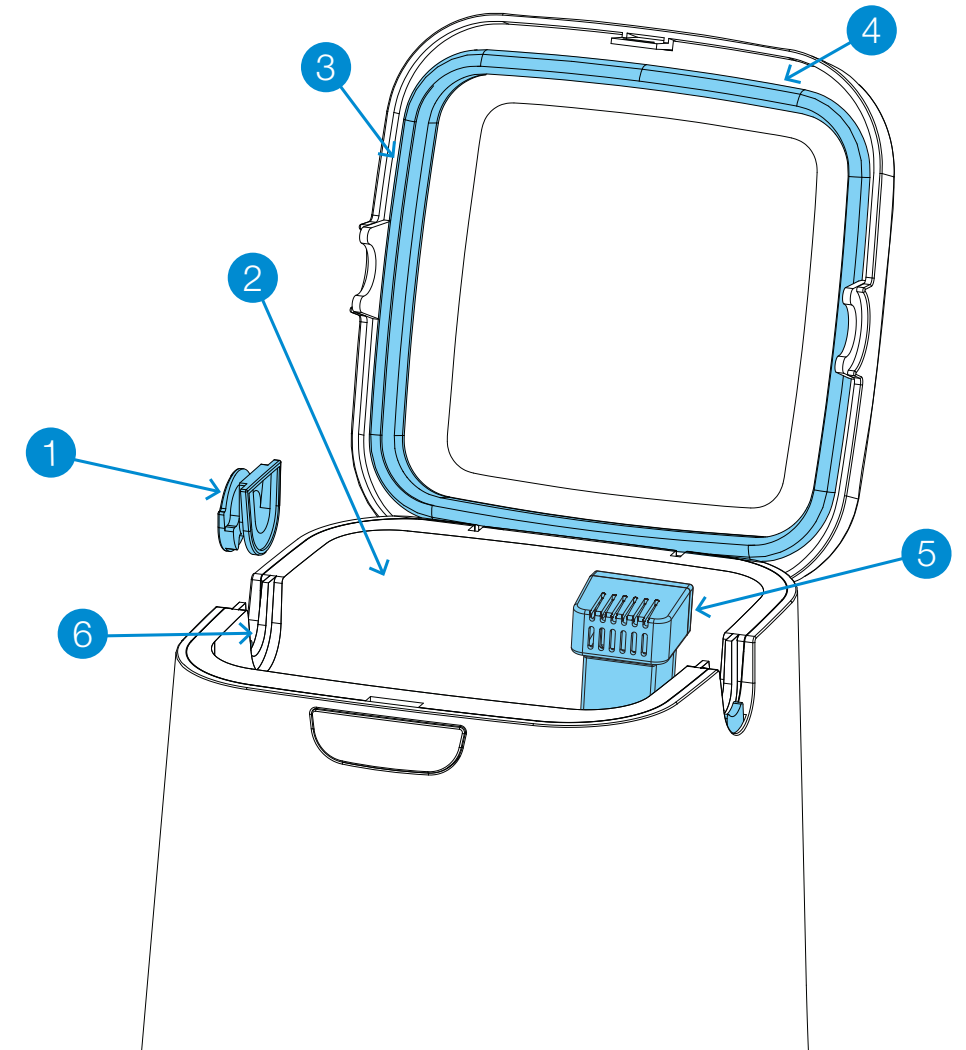

INCLUDED WITH YOUR SOCLEAN 2

Number	Part Name	SKU	Description
7	Control Panel	N/A	Buttons, display, and Cycle light indicator for SoClean 2 functions.
8	Ozone Tube A	N/A	You will only be using Ozone Tube A, the longest section of black tubing which carries ozone from the SoClean 2 through the sleep equipment hose and mask.
9	Check Valve	N/A	The Check Valve is not required for use with the Hose and Mask Adapter
10	Injection Fitting	N/A	The Injection Fitting is not required for use with the Hose and Mask Adapter
11	Power Supply	PN1222	Supplies power to your SoClean 2.

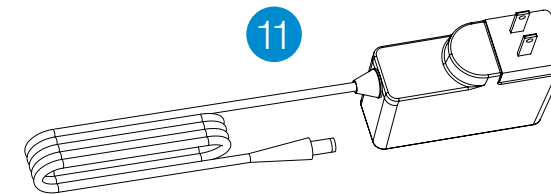
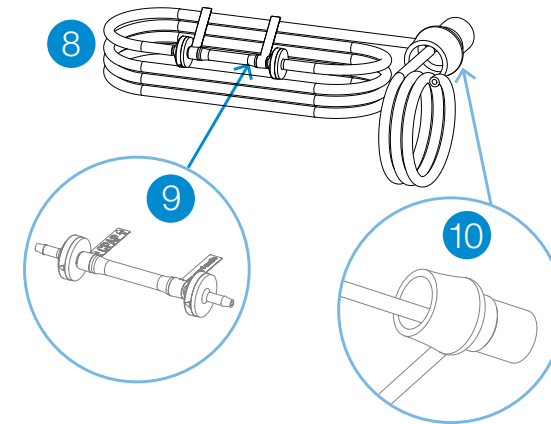
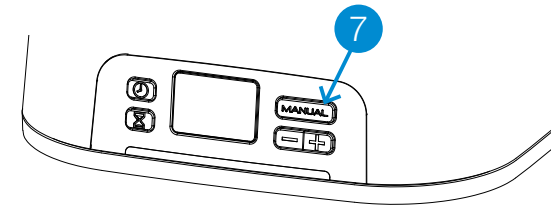

Replacement Parts

A message appears on your SoClean 2 after a certain amount of use (typically around six months) as a reminder to replace the Cartridge Filter. To reorder supplies, contact your authorized reseller or visit SoClean.com.

Follow your sleep equipment manufacturer's instructions for cleaning your sleep equipment hose and mask with mild, unscented soap and warm, drinking-quality water.

Replacement Parts

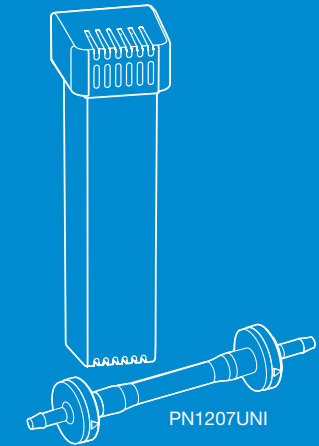

The Check Valve is not required for use with the Hose and Mask Adapter.



WARNING: Please purchase your Cartridge Filter Kits from SoClean® only. Authentic Cartridge Filter Kits can be purchased from SoClean via multiple online marketplaces, such as Amazon® in addition to SoClean.com, however please confirm that the seller of your Cartridge Filter Kit is SoClean, and not any other seller, to ensure the authenticity of your Cartridge Filter Kit. SoClean has discovered counterfeit Cartridge Filter Kits being sold, particularly on Amazon® and eBay®, with check valves and filters, that leak and can cause damage to your SoClean machine or to your property due to water leakage from the counterfeit check valves. Please contact SoClean immediately if you have had any issues with your Cartridge Filter Kit. Amazon® is a registered trademark owned by Amazon Technologies, Inc. eBay® is a registered trademark owned by eBay, Inc. SoClean® is a registered trademark owned by SoClean, Inc.

SOCLEAN 2 CONTROL PANEL

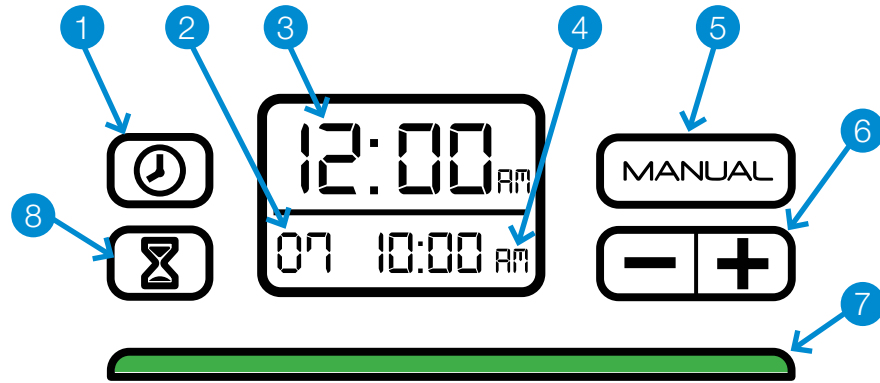

WARNING: In the event of loss of power to your home or the SoClean 2, ensure the correct Clock time and Daily Start Time are set on the SoClean 2 before using your sleep equipment. Failure to do so may result in the SoClean 2 operating at an unexpected time.

Number	Button(s)/Display	Description
1		Sets the clock.
2	Cycle Run Time (Duration)	The duration, in minutes, of the Cycle. The default Cycle Run Time is set to 7 minutes.
3	Current Time	The current time. Default time set to 12:00am.
4	Daily Start Time	The time of day when the Cycle starts. Default Daily Start Time is set to 10:00am.
5		Starts a Cycle immediately. The scheduled Cycle will still occur.
6		Decreases (-) or increases (+) time.

Number	Button(s)/Display	Description
7	Status Light	The light below the display indicates the Cycle status. A green light indicates that the Cycle is complete, and you can remove your mask from the SoClean Chamber and use your sleep equipment. RED – The SoClean 2 is operating and generating ozone. YELLOW – The 2-hour Cycle is still active. The ozone is working and dissipating. GREEN – Cycle is complete. You can use your sleep equipment any time. The light turns off when you open the Lid. Wait a minimum of 30 minutes between completion of the Cycle and use of the sleep equipment mask and hose.
8		Sets Daily Start Time.
		Changes clock to 24-hour or 12-hour format.

Messages

The SoClean 2 display panel shows messages that can require action. This list shows the messages and how to correct them:

Message	What to Do
Hose not present. Cycle will not run.	Ensure that the hose is seated securely in the hose slot. Check that the Removable Hose Slot Plug is seated correctly on the other side.
Order Filter Kit.	Your Cartridge Filter has reached the end of its life based on your use.
Cycle in process. Do not open the lid!	Ozone present. The SoClean 2 is performing a Maintenance Cycle in a well ventilated room. While the SoClean 2 Maintenance Cycle is in progress, leave the room. The green Cycle indicator light means it is complete. You can now open the Lid. Wait a minimum of 30 minutes between completion of the Cycle and use of the sleep equipment mask and hose.

WASH, RINSE AND DRY YOUR SLEEP EQUIPMENT HOSE AND MASK

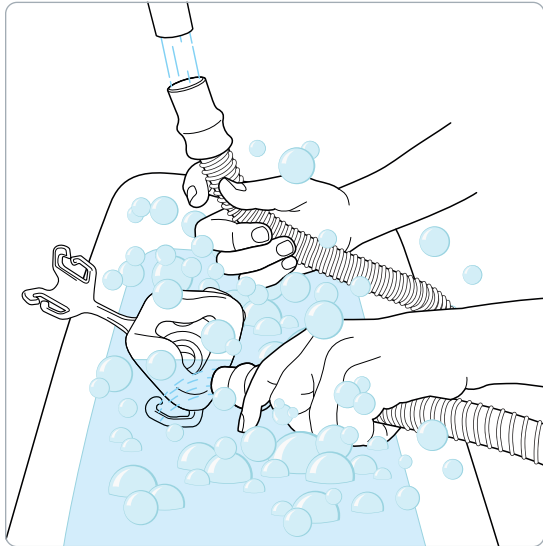

Wash, rinse, and dry your hose and mask as recommended by the manufacturer.

Your SoClean 2 should be used as a supplement to your cleaning routine, not a replacement.

Washing removes oils, films, debris and other build up that can naturally form on your mask and hose from use.

USING THE HOSE AND MASK ADAPTER WITH YOUR SOCLEAN 2



To use the Hose and Mask Adapter with your SoClean 2:

Detach **Ozone Tube A** from the included **Check Valve** or your previous **SoClean Adapter**.
Move on to Step 1.

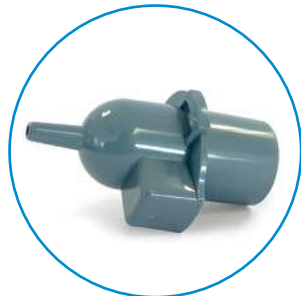
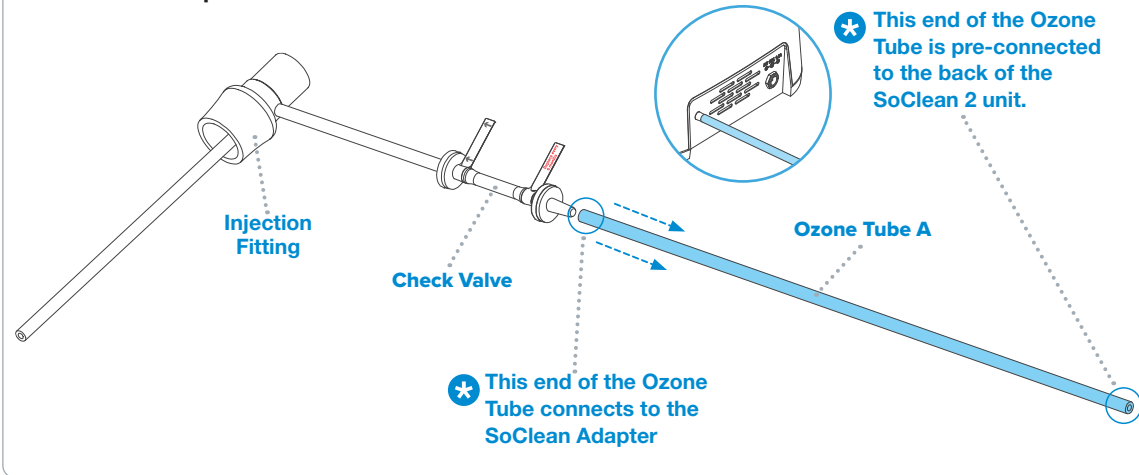

SoClean Adapter



IMPORTANT: This adapter needs to fit snugly.
 If the fit appears too tight, do not force adapter into tubing.
 If the adapter is loose, call Customer Care at 866-501-3705.

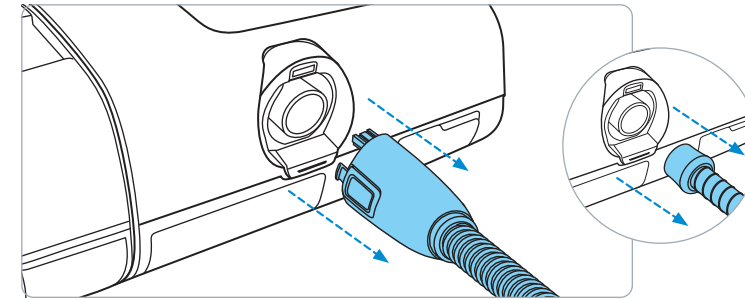

1. Remove the hose from your sleep equipment machine.

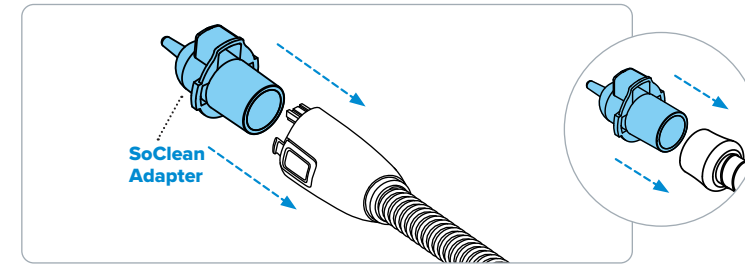

2. Install the SoClean Adapter onto the sleep equipment hose.

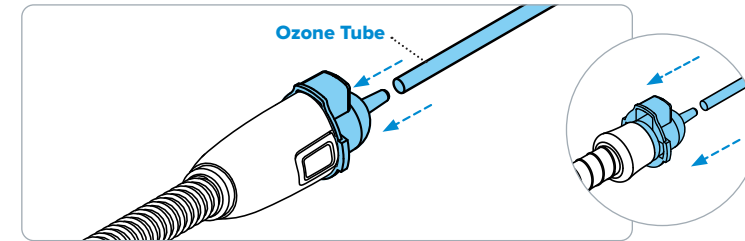

3. Connect the Ozone Tube to the So Clean Adapter.



WARNING: The Ozone Tube must always be connected to the SoClean Adapter and the back of the SoClean 2 unit when operating the SoClean 2.

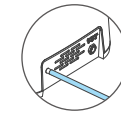

USING THE HOSE SLEEVE [OPTIONAL]

The SoClean requires a snug fit around the hose when placed into the hose slot and the lid is closed. If there is space around the hose and this is not achieved, the SoClean will not operate.

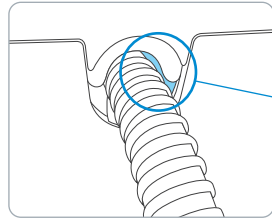

If there is visible space around the hose when placed in the hose slot, you may be using a 12 mm hose and require the Hose Sleeve be installed.

The Hose Sleeve is required if you use a 12 mm hose. It is not compatible with 15 mm or larger diameter hoses.

An extra sleeve is included in the event of sleeve breakage. You will only use one Hose Sleeve at a time.

The images shown are actual size and can be used to determine which hose you have.

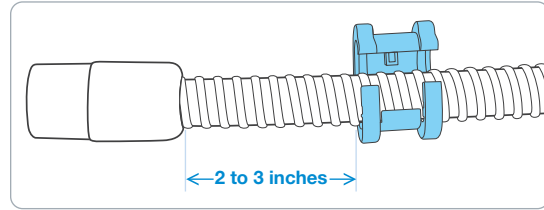
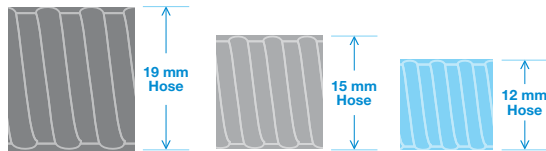

1. Position the Hose Sleeve 2 to 3 inches from the connector.

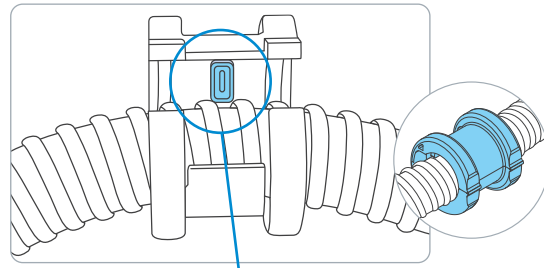

2. Position the hose on the Nub side of the Hose Sleeve. Slide the hose until the Sleeve “clicks” into place between two of the hose ribs and close the Sleeve.

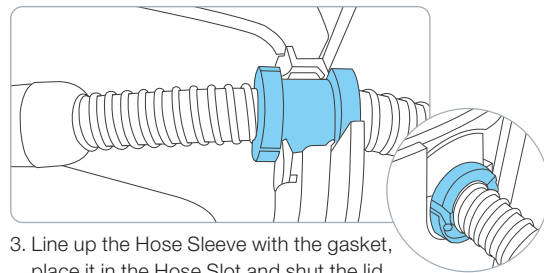

3. Line up the Hose Sleeve with the gasket, place it in the Hose Slot and shut the lid.

CONNECT POWER

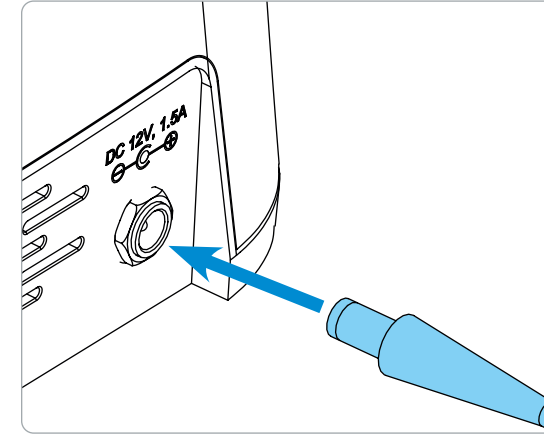

Plug the Power Supply into the connector marked DC 12V, 1.5A on the back of the SoClean 2. The Power Supply should be plugged into a wall outlet that is easy to access and observe.

WARNING: In the event of loss of power to your home or the SoClean 2, ensure the correct Clock time and Daily Start Time are set on the SoClean 2 before using your sleep equipment. Failure to do so may result in the SoClean 2 operating at an unexpected time.

SET LANGUAGE

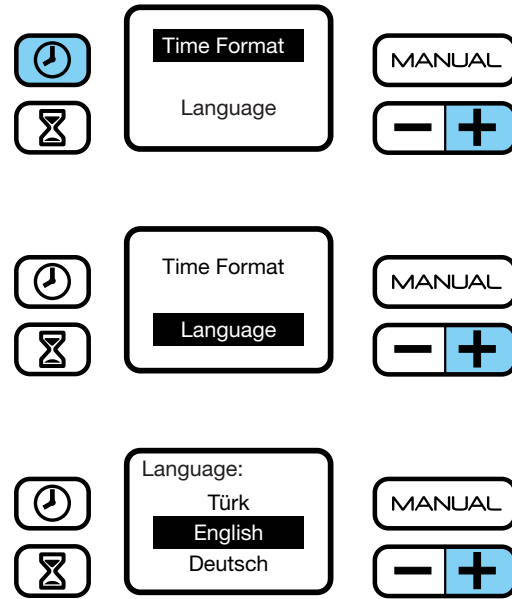

Language

To choose correct language:

1. Press the **+** and **⏸** buttons simultaneously.
2. Choose 'Language' by using the **+** button.
3. With 'Language' selected, press the **MANUAL** button
4. Scroll through language options by using the **+** button.
5. Press the **MANUAL** button to select language of choice.
6. Press the **⏸** button to save.

SET CLOCK & CYCLE SCHEDULE

! WARNING: Ensure the correct Clock time and Daily Start Time are set on the SoClean 2 before using your sleep equipment. Pay particular attention to the AM/PM setting if using 12-hr mode. Failure to do so may result in the SoClean 2 operating at an unexpected time.

! WARNING: In the event of loss of power to your home or the SoClean 2, ensure the correct Clock time and Daily Start Time are set on the SoClean 2 before using your sleep equipment. Failure to do so may result in the SoClean 2 operating at an unexpected time.

If you unplug the SoClean 2 or experience a power loss, you will need to reset the current time only. The settings will remain saved. For safe use, operate your SoClean 2 only as instructed in this User Manual.

The SoClean 2 comes preset to start a 7 minute Cycle at 10:00am daily. However, **you must set the clock to your current time.** The following procedures describe how to set the clock, schedule and start the Cycle immediately.

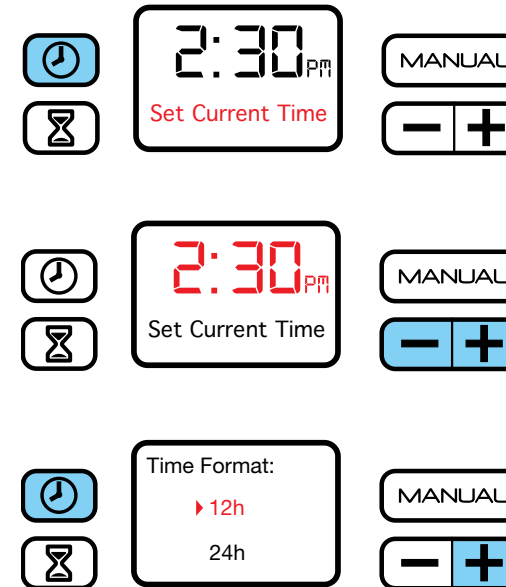

Set the Clock/Current Time

1. Press the **⏸** button.
2. Change the time by pushing either the **-** or **+** button until your current time is reached. By holding down the button the time moves faster. Press the **⏸** button once more to store your time and return to the home screen.

Set Time Format

Default is 12 hour format.
To display in 24-hour format (military time):



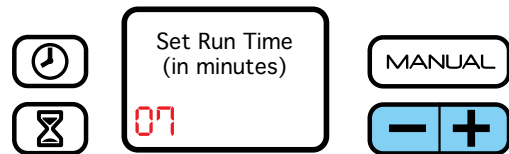
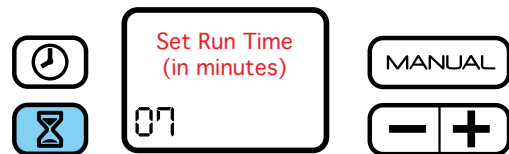

1. Press the **+** and **⏸** buttons simultaneously.
2. With 'Time Format' selected, press the **MANUAL** button
3. Choose either the 12 or 24-hour format by using the **+** button.
4. Press the **MANUAL** button to select preferred setting.
5. Press the **⏸** button to save.





Cycle Settings

Set Cycle Run Time (duration) and Schedule the Daily Start Time

These two processes follow each other in this setup.

1. Press and release the  button to display the menu pictured on the left.
 2. Press and release the  or  button to decrease or increase the number of minutes of your Cycle Run Time.
- Note:** The default Cycle Run Time of 7 minutes is recommended.
3. Press and release the  button again to save your Cycle Run Time and schedule the Daily Start Time. To skip the Daily Start Time setup, press the  button again when you reach this step.

Note: The default Daily Start Time is 10:00am.

4. Press and release the  or  buttons to reach the desired Daily Start Time. Press the  button again to save and return to the home screen.

Note: Your SoClean 2 should be operated in a well ventilated room. The entire process requires 2 hours plus the Cycle run time to complete. Leave the room during the Maintenance Cycle. A green indicator light means that the Cycle has completed. Wait a minimum of 30 minutes between completion of the Cycle and use of the sleep equipment mask and hose.

Remove the Removable Slot Plug and place inside the SoClean Chamber.



Manual Mode

Ensure the SoClean 2 is being operated in a well ventilated room and that your mask and hose are in place and the SoClean Lid is closed.

1. Press and release the  button to begin the Cycle.

The Maintenance Cycle starts immediately and requires 2 hours plus the Cycle run time to complete. Leave the room during this time. Wait for the green light before removing your mask. It's not necessary to remove your mask immediately after observing the green light. Wait a minimum of 30 minutes between completion of the Cycle and use of the sleep equipment mask and hose.

! WARNING: In the event of loss of power to your home or the SoClean 2, ensure the correct Clock time and Daily Start Time are set on the SoClean 2 before using your sleep equipment. Failure to do so may result in the SoClean 2 operating at an unexpected time.

USING YOUR SOCLEAN 2

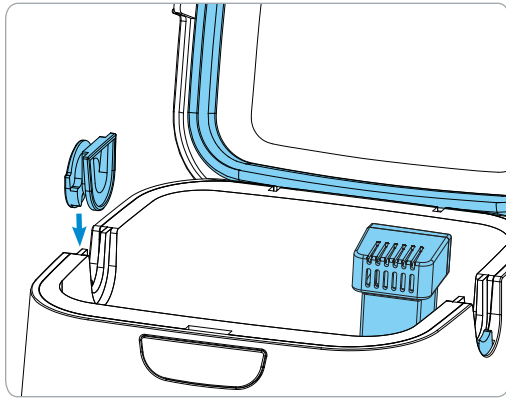

WARNING: Do not physically alter the Hose Detect Switches on the SoClean 2. Regularly inspect your SoClean 2 for physical damage, such as cracks or broken structure, damaged gaskets, and cracks in the sleep equipment hose. Discontinue use if damage is detected and contact SoClean for assistance.

1. Open the lid.
2. Install the Removable Hose Slot Plug into one open slot.

Orient the Removable Hose Slot Plug as shown above. The round face of the Removable Hose Slot Plug is outside of the SoClean 2.

Note: Your mask and hose can insert from either side of the SoClean 2. To change sides, remove the Removable Hose Slot Plug by lifting it straight out, and insert it into the slot on the opposite side.

3. **Remove outer plastic wrapping and blue tape from the Cartridge Filter** and fully seat it in the Cartridge Filter Slot at the back-right corner of the SoClean Chamber. Ensure proper installation by orienting the Cartridge Filter vents to face the front of the machine.

4. Insert your mask into the SoClean Chamber allowing its attached hose to rest in the open hose slot, opposite the Removable Hose Slot Plug.

5. Close the Lid with the hose placed in the open slot. The SoClean 2 will now automatically operate according to its preset time and duration.

Note: The SoClean 2 won't operate without the mask and hose present in the closed SoClean Chamber. Additionally, the SoClean 2 will not operate if the Removable Hose Slot Plug is missing or improperly seated.

WARNING: Keep the SoClean Lid closed until the green status light illuminates (approximately 2 hours after completion of the Cycle).

It is necessary to let the mask remain in the closed SoClean Chamber for at least **2 hours and 10 minutes** to ensure that the ozone performs its function and dissipates appropriately. After that period, the status light shines green and the mask is ready to be removed from the SoClean Chamber. **Wait a minimum of 30 minutes between completion of the Cycle and use of the sleep equipment mask and hose.**

Ozone quickly dissipates in the atmosphere. If you accidentally interrupt the Cycle and release ozone by opening the Lid, simply step away from the SoClean **2 hours and 10 minutes** to avoid unintended exposure.

Note: Your mask and hose will not be fully maintained if you interrupt the Cycle; therefore, it is recommended that you restart the Cycle.

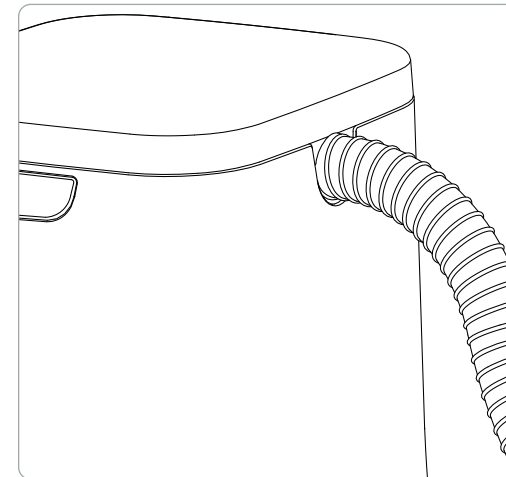
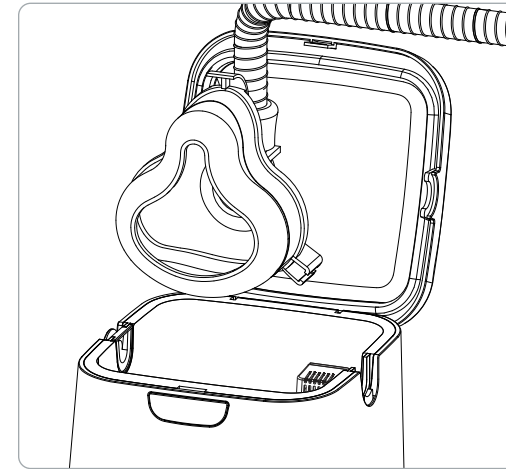

6. Once the Cycle has completed (status light will be green), open the Lid and remove the mask.

7. Remove the Removable Slot Plug and place inside the SoClean Chamber. Run your sleep equipment for 1-2 minutes before putting your mask on.

Tip: Placing the Removable Slot Plug into the SoClean Chamber helps prevent accidental loss of the Removable Slot Plug.

WARNING: Do not route your sleep equipment hose through both Hose Detect Slots while or after using your equipment. This may result in the SoClean 2 running at an unexpected time.



WARNING: Only rest the flexible section of the sleep equipment hose not the rigid connector in the Hose Detect Slot

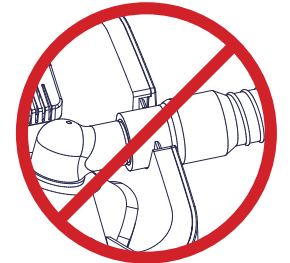

RECONNECTING YOUR SLEEP EQUIPMENT

Once the Maintenance Cycle is complete and you are ready to use your sleep equipment hose and mask, wait a minimum of 30 minutes between completion of the Cycle and use of the sleep equipment mask and hose.

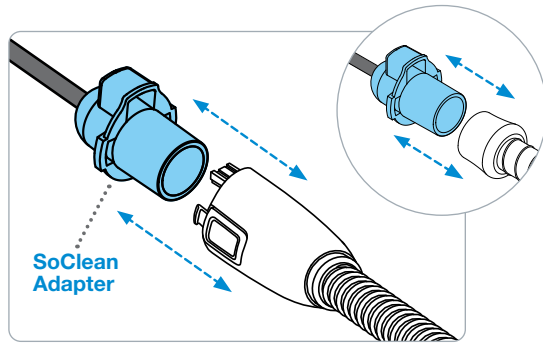

1. Remove the SoClean Adapter from your hose.

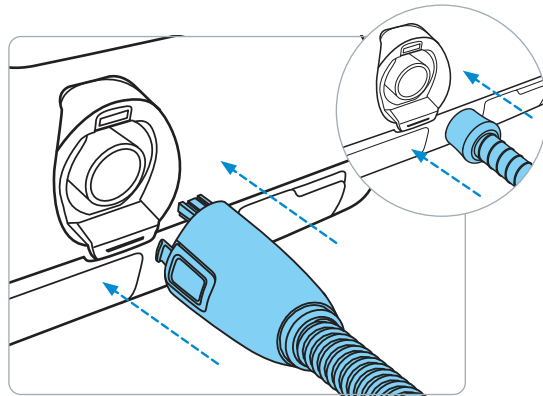

2. Reconnect your hose to the sleep equipment machine hose port.

CARE & MAINTENANCE OF YOUR SOCLEAN 2

Wipe down the SoClean 2 with a damp cloth.

! WARNING: Do not submerge or fill the SoClean 2 with water!

The SoClean Cartridge Filter Kit should be replaced every 6 months. A reminder message on the display will appear after approximately six months, depending on usage.

To reorder supplies (Cartridge Filter Kit), contact your authorized reseller or visit **SoClean.com** and search for the desired part or contact customer care.

Please remember to reset your SoClean 2 after installing the new Cartridge Filter as described in the instructions that come with the replacement.



Please purchase your Cartridge Filter Kits from SoClean® only. Authentic Cartridge Filter Kits can be purchased from SoClean via multiple online marketplaces, such as Amazon® in addition to SoClean.com, however please confirm that the seller of your Cartridge Filter Kit is SoClean, and not any other seller, to ensure the authenticity of your Cartridge Filter Kit. SoClean has discovered counterfeit Cartridge Filter Kits being sold, particularly on Amazon® and eBay®, with check valves and filters, that leak and can cause damage to your SoClean 2 machine or to your property due to water leakage from the counterfeit check valves. Please contact SoClean immediately if you have had any issues with your Cartridge Filter Kit.

Amazon® is a registered trademark owned by Amazon Technologies, Inc. eBay® is a registered trademark owned by eBay, Inc. SoClean® is a registered trademark owned by SoClean, Inc.

FAQ

1. Will my sleep equipment be wet from the SoClean 2?

No. No fluids or water are used in this process. If you observe water, please contact customer care at 866-501-3705.

2. Is the SoClean 2 harmful to me or the environment?

No. SoClean 2 produces ozone in a closed system and includes a Cartridge Filter which helps convert ozone back to regular oxygen. Wait a minimum of 30 minutes between completion of the Cycle and use of the sleep equipment mask and hose.

3. How do I know that my SoClean 2 is operating properly? After the Cycle has successfully completed, the status indicator light will illuminate green.

Your sleep equipment will have a light, clean scent. If you have questions about the operation of your SoClean 2 please contact customer care at 866-501-3705.

4. What if the scent the SoClean 2 leaves is too strong for me? If you smell ozone or any other strong odor, air out the mask and hose by:

- Running your sleep equipment for 1-2 minutes before putting your mask on

If the device still produces a strong odor, try the following:

- Wash your sleep equipment mask and hose based on manufacturer's instructions.
- Use a mask wipe to clean your mask before putting it on.
- Make sure the Cartridge Filter is present, the clear plastic wrapping and blue sticker have been removed from the Cartridge Filter and that the black gasket is rolled up under the lip. Finally, make sure the Cartridge Filter is oriented correctly in the slot.

5. What if my indicator light is shining red or yellow?

This means that the Cycle is not yet complete. Do not open the Lid until the light turns green at which point you can remove your sleep equipment from the SoClean Chamber. Wait a minimum of 30 minutes between completion of the Cycle and use of the sleep equipment mask and hose.

6. It has been more than two hours since the SoClean 2 completed a Cycle, but the status light is still yellow.

Why? Some types of indoor lighting make it difficult to distinguish the yellow and green lights on the SoClean 2. Confirm that the green light is visible before opening your SoClean 2 to ensure that the Cycle is complete, and your sleep equipment is ready for use. Wait a minimum of 30 minutes between completion of the Cycle and use of the sleep equipment mask and hose.

7. What if the indicator light is off after a scheduled Cycle? The SoClean 2 light is green when a Cycle completes successfully. If there is no light, the Cycle did not start.

Common reasons for this are that the SoClean 2 is not powered, the Lid was not securely closed, there was no sleep equipment in the SoClean Chamber at the scheduled Daily Start Time or the Removable Hose Slot Plug is missing or not properly seated. If everything looks good, then close the Lid and press the **MANUAL** button to test. Any error message will appear on-screen. Please call customer care if you need further assistance.

8. What if I missed my scheduled Daily Start Time, but still wish to run it? You can use the Manual function to run a Cycle as long as you still have 2 hours and 30 minutes remaining before you go to sleep.

9. Why does my display say Order Filter Kit?

This message appears approximately every 6 months, depending upon usage, as a reminder to regularly replace the Cartridge Filter Kit. To reorder, contact your authorized reseller or visit SoClean.com.

When you're ready to replace the Cartridge Filter Kit follow the instructions that come with it and ensure you do the following:

- Make sure you remove the clear plastic wrapper and blue tape from the Cartridge Filter
- Reset the Filter countdown by pressing the manual and hourglass buttons at the same time for about 3-5 seconds. You will see a smiley face on the display once it has reset which confirms that process is complete

10. Are there materials that I should avoid putting into the SoClean 2? Do not use incompatible materials in the SoClean 2 such as memory foam, natural rubber, or nylon. Headgear often contains incompatible materials for your SoClean 2. Remove headgear before placing mask in the Maintenance Chamber.

11. My mask feels oily, what should I do? Skin can leave oil behind on your sleep equipment so you should always hand-wash your equipment as recommended by the manufacturer. You may wipe your mask with SoClean's Mask Wipes.

12. How often should I wash my sleep equipment mask and hose?

Follow your sleep equipment manufacturer's instructions for cleaning your sleep equipment hose and mask with mild, unscented soap and warm, drinking-quality water.

13. If I lose power, do I need to reset my SoClean 2?

In the event of loss of power to your home or the SoClean 2, ensure the correct Clock time and Daily Start Time are set on your SoClean 2. Failure to do so may result in the SoClean 2 operating at an unexpected time. For instructions on how to set your Clock and Daily Start Time. If you need assistance with the reset, please call customer care at 866-501-3705.

This page is intentionally left blank.

This page is intentionally left blank.

For warranty information visit **SoClean.com/warranty.**

For further questions or concerns, or for more information about
SoClean 2 or our other innovative products, please visit:

SoClean.com



866-501-3705

Copyright © 2011-2023

SoClean® is a registered trademark of SoClean, Inc.

1 Vose Farm Road, Peterborough, NH U.S.A. 03458

Patent: SoClean.com/patents